

ERGO CUSHION FRAME BRACKET SERVICE KIT

Assembly Instructions

PARTS LIST

1x Service bracket – 7227047

2x Washer – 30870507

2x M6 Fastener – 7219906

2x Nylock nut – 336676

2x Trim screw – S2003023

1x 3 inch Velcro strip –
30809007

1x Rake Adjust knob – 364052

1x Knob clip – 311.881.247

TOOLS NEEDED

1x Phillips #2
screwdriver

1x M10 hex nut driver

1x Small adjustable
wrench or clamping tool

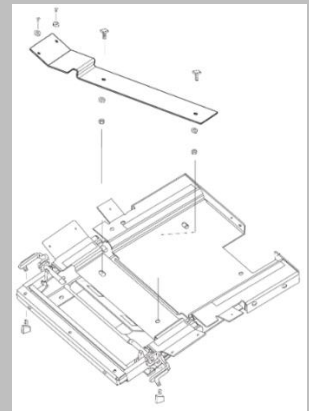

INSTRUCTIONS

STEP 1: Raise the cushion angle to the highest position. Pull up the back of the seat cushion foam to expose the cushion frame (figure 1).

FIGURE 1



STEP 2: Remove the 2 fasteners on the right-hand control panel using a Phillips #2 screwdriver. Gently pull the control panel off the frame, routing around the rake adjust knob (figure 2).

FIGURE 2



STEP 3: Remove small strip of Velcro from the frame (figure 3).

FIGURE 3



STEP 4: Obtain the new bracket kit and align to holes on the frame. Place M6 bolt through the top, the large washer and nut on the bottom and hand tighten (figure 4).

FIGURE 4



STEP 5: Compare the angle between the new bracket and the cushion frame. To reinstall the control panel, the bend on the cushion frame needs to match as closely as possible to the new bracket. Use a small adjustable wrench to bend the side of the ERGO frame upwards (figure 5).

FIGURE 5



STEP 6: Add a new piece of Velcro to the bracket (figure 6).

FIGURE 6

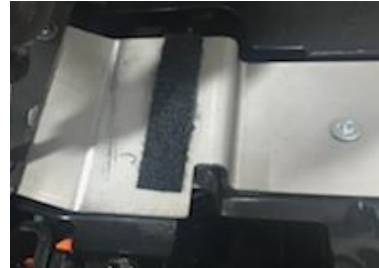

STEP 7: Place spring clip onto the rake adjustment lever on the cushion frame (figure 7).

FIGURE 7



STEP 8: Confirm control panel screw holes are aligned to the clearance hole on the service bracket. Reinstall control panel onto the cushion frame and install new longer trim screws and small washer using Phillips #2 screwdriver (figure 8).

FIGURE 8



STEP 9: Completely tighten the attachment bolts with Phillips #2 screwdriver and M10 hex nut driver (figure 9).

FIGURE 9



STEP 4: Replace cushion foam assembly onto the frame.



Part numbers: 7227511

Performance Seats, Inc
24801 Capital Blvd , Clinton Twp, MI 48036 USA
Main: +1 800-873-2276