

ERGO 3 POINT SEAT BELT INSTRUCTIONS

Assembly Instructions

TOOLS NEEDED

- 1x Phillips #2 screwdriver
- 1x small pick or flat head screwdriver
- 1x large flat head screwdriver
- 1x 5/8" wrench/socket
- 1x 13 mm wrench/socket
- 1x 6 mm Allen wrench
- 1x Torque wrench



INSTRUCTIONS

STEP 1: Remove hole plugs from lower rear trim panel using small pick. Save for re-use. Remove rear lower trim panel using Phillips #2 screwdriver. Set aside caps, screws, and panel (figure 1).

FIGURE 1

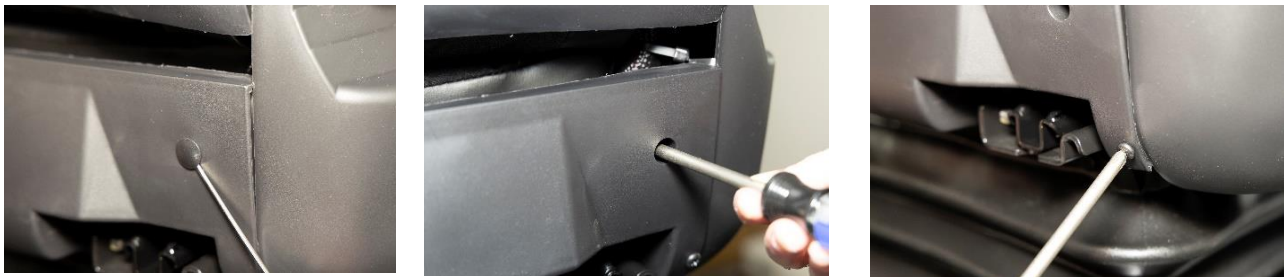

STEP 2: AM80: Remove 4 small caps with small pick from plastic back protector to allow access to 4 mounting screws. Remove 4 screws with Phillips #2 screwdriver. AM384: Remove 2 small caps with small pick from the plastic back protector to allow access to the 2 mounting screws. Set aside caps & screws. Remove plastic back protector (figure 2).

FIGURE 2



STEP 3: If the seat has a fixed D Ring, using a Phillips screwdriver, remove the c channel bracket trim cover. Set cover and screws aside (figure 3).

FIGURE 3



STEP 4: Remove 5/8" nut cap. Disassemble the turning loop from the bracket with a 5/8" socket/ratchet and 5/8" wrench (figure 4).

FIGURE 4

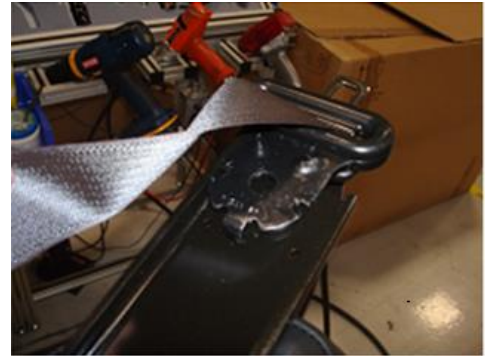

STEP 5: Remove retractor assembly from cushion frame with 13 mm hex wrench for the nuts, a 13 mm hex wrench for one bolt (shown), and a 6 mm Allen wrench for the other bolt (figure 5).

FIGURE 5



STEP 6: Lift back of cushion foam to remove from the Velcro pieces securing to the cushion frame. Flip cushion foam forward over thigh extension to access the side trim panel.

STEP 7: Remove left rear trim panel by removing the screw securing to the cushion frame with a Phillips #2 screwdriver. Remove the recliner hand wheel by prying it off with a large flat head screwdriver. Slide panel upward along seat belt webbing to access the lap anchor bolt mounting location (figure 6).

FIGURE 6

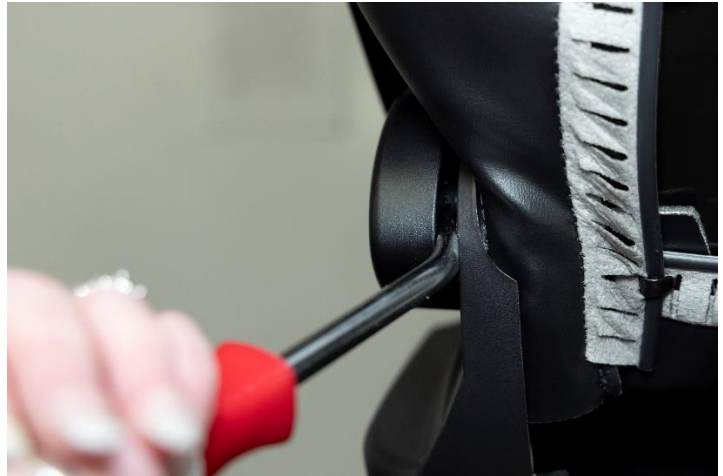

STEP 8: Remove lap anchor bolt from the cushion frame using a 5/8" hex wrench. Set aside washers and bolt. If the seat also has a 2 point lap belt retractor, set aside (figure 7).

FIGURE 7

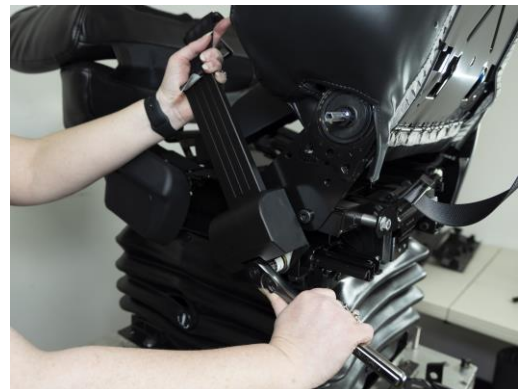

STEP 9: Remove old seat belt assembly from the seat.

STEP 10: Install new seat belt assembly at the retractor attachment first. with the 2 holes on the back of the cushion frame. Shown is a graphic for the correct arrangement of bolts and spacers used to install the retractor. Secure bolts to 22 Nm. (figure 8).

FIGURE 8

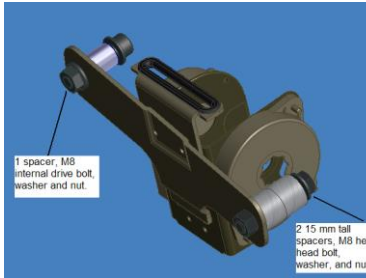

STEP 11: After securing retractor, remove the plastic shipping clip from the webbing. **NOTE:** It is important to wait until the retractor is installed before removing the shipping clip. If removed prior to installation, too much webbing may feed into the retractor spool, preventing the retractor from working properly (figure 9).

FIGURE 9



STEP 12: Route turning loop up to the mounting location, ensuring that there are no twists in the webbing. Install turning loop to mounting bracket on the top of the seat back with 7/16-20 bolt. For a seat with a Fixed D Ring, using a 5/8" socket, torque to 50 Nm. For a seat with an adjustable D-Ring, add the 7/16-20 lock nut on the front of the seat assembly and, using a 5/8" wrench and socket, torque to 50 Nm.

STEP 13: For seats with a Fixed D Ring, install 5/8" hex cap over the weld nut. For seats with a Fixed D Ring and a seat belt presenter, install the presenter over the nut and secure using the 7/16-20 lock nut. Add a dab of silicone adhesive into the round cap and place over the lock nut. For seats with an Adjustable D Ring, add a dab of silicone adhesive into the round cap and place over the lock nut. Place the small cap over the bolt head on the back of the assembly. (figure 10).

FIGURE 10



STEP 14: Route the lap anchor through the opening in the left side trim panel, ensuring there are no twists in the webbing. Place the 3/8" washer on the bolt, then the anchor, and then 7/16" washer on the other side of the anchor. Install the bolt into the attachment location on the seat. Torque to 50 Nm (figure 9).

FIGURE 11



STEP 15: If the seat also has a 2 point retractor, place the 3/8" washer on to the bolt, then the 2 point retractor, then the lap anchor. Torque to 50 Nm (figure 12).

FIGURE 12



STEP 16: Slide the side trim panel down the webbing, and align over the mounting location on the cushion frame. Secure the screw with a Phillips #2 screwdriver. Reinstall recliner hand wheel onto the transmission rod. The handwheel is keyed to align with the shape on the rod (figure 13).

FIGURE 13



STEP 17: Reinstall cover over turning loop using a Phillips #2 screwdriver (figure 14).

FIGURE 14



STEP 18: AM80: Reinstall plastic back protector using a Phillips #2 screwdriver. Reinsert 4 hole plugs, using a small rubber mallet if necessary. Ensure that the top of the plastic back protector near the seat belt turning loop is routed through the loop of fabric sewn into the trim cover (figure 15).

FIGURE 15



STEP 19: AM384: Reinstall plastic back protector by aligning the 2 hooks at the base of the panel to the cut out in the back frame. Ensure that the seat belt webbing is OUTSIDE of the back panel and not in between the back and the plastic. Reinstall the 2 small screws at the top of the panel using a #2 Philipps screwdriver. Reinsert 2 hole plugs, using a small rubber mallet, if necessary (figure 16).

FIGURE 16



STEP 20: To replace the buckle, on the right hand side of the seat, remove the recliner hand wheel and the rear side trim panel, as was removed for the retractor removal. Remove the buckle with a 5/8" socket. If the seat is equipped with a seat belt alarm, disconnect the buckle wire harness connector from the jumper harness and remove the zip ties securing it to the cushion frame. (figure 17).

FIGURE 17

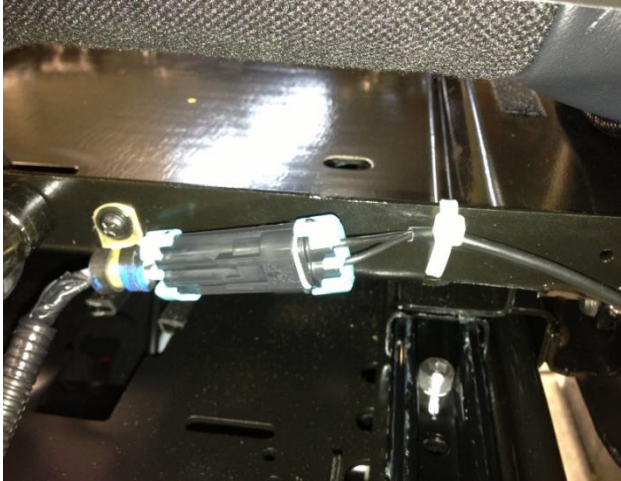

STEP 21: Install the new buckle onto the seat using the 7/16-20 shoulder bolt, washer and spacer. Torque to 50 Nm. If the seat was equipped with seat belt alarm, connect the harness to the jumper harness. Add zip ties to the back of the cushion frame to hold the harness secure. If the seat does not have alarm, the harness can be cut off the buckle assembly at the base of the heat shrink tubing. (figure 16).



FIGURE 18

STEP 22: Reinstall the rear side trim panel and recliner hand wheel on the right hand side of the seat, as was completed on the left hand side of the seat.

STEP 23: Reinstall rear trim panel over the seat belt retractor on the back of the cushion frame with 2 screws using a Phillips #2 screw driver. Install 2 pan head screws to the lower corners of the rear trim panel to the left and right side trim panels. Insert hole plugs into the 2 holes in the rear trim panel (figure 19)

FIGURE 19



Part numbers: 7227121E & 7227124E

⚠ CALIFORNIA PROPOSITION 65 WARNING ⚠

WARNING: This product contains chemicals known to the State of California to cause cancer and birth defects, or other reproductive harm.

ADVERTNCIA: Este producto contiene productos químicos reconocidos por e estado de California que provocan cáncer, defectos de nacimiento u otros daños reproductivos.

For more information: www.P65Warnings.ca.gov